



Design and manufacture of agricultural machinery

Parts and Accessories



74 –92 Buckland Street

PO Box 665

Toowoomba Qld 4350

PH: (07) 4636 9100

FAX: (07) 4636 9140

www.excelagr.com.au



INDEX

•	Toolbars	4
•	Linkages	5
•	Depth gauge Wheels	6
•	Shanks & Clamps	7& 8
•	Coulter Mounts	9
•	Hubs & Stubs	10
•	Clean Sweep Information	11
•	Row Units	12
•	Accessories	13

TOOLBARS

Available from 4metres - 24 metres in Linkage or Trailing

Std 8" x 8" Toolbar

P/N 330015

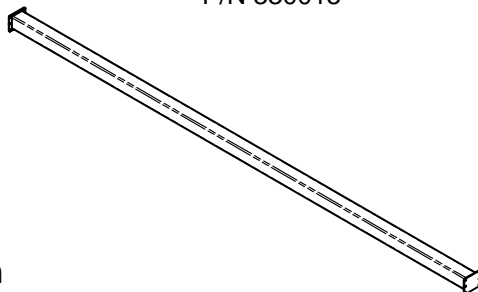

Stiffener Beam

P/N 330030

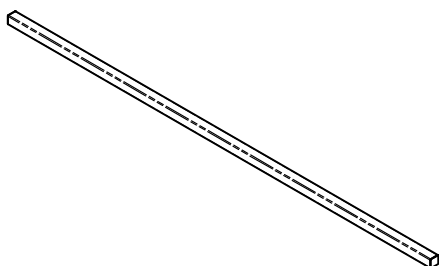

Beam Stand

P/N CV330040

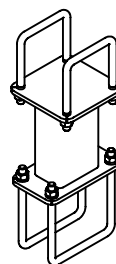

Stabiliser Kit

P/N CV330020

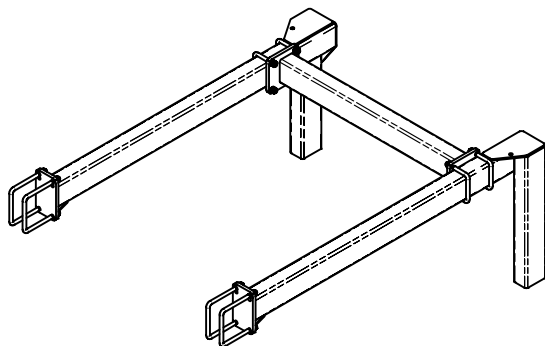

Lift Assist Kit

P/N SW 405285

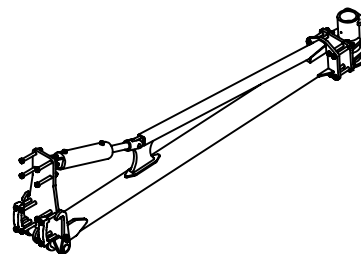

Linkage Bar 8m

P/N 403155

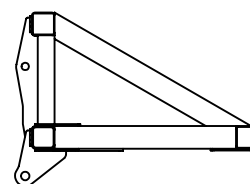
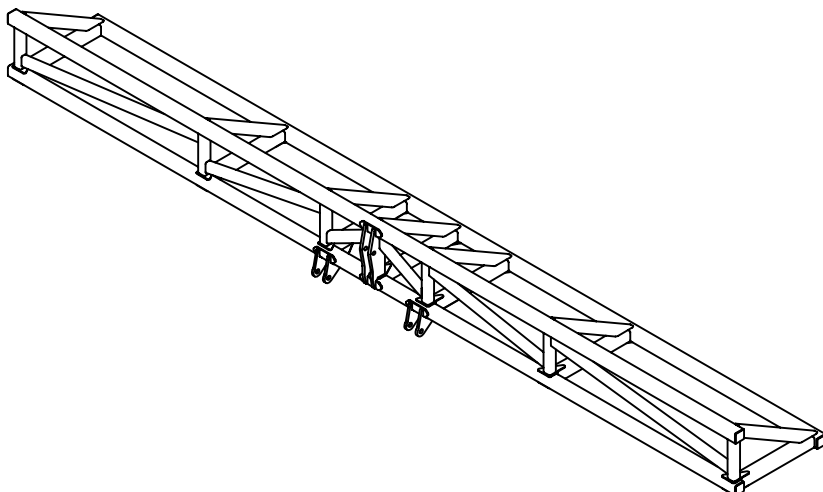

Side View

LINKAGES

Excel has a large range of 3 Point Linkages
in various categories to suit different size Toolbars.
Also available in Diamond-bar configuration. Includes all Ubolts & Pins.

Std 3 Point Linkage (Cat:3) P/N CV 330000

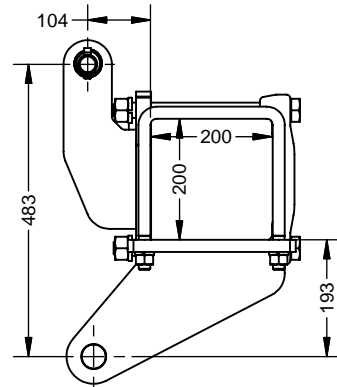
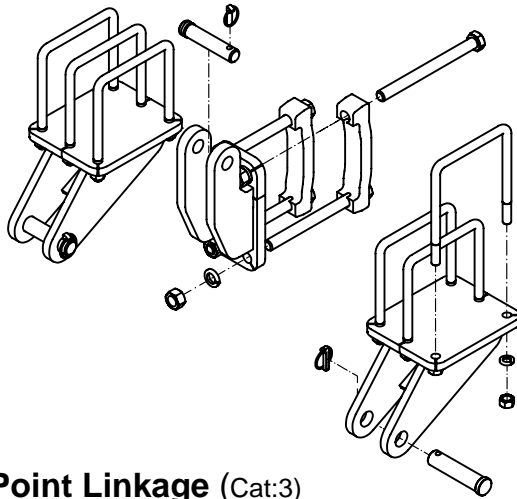

High Lift 3 Point Linkage (Cat:3) P/N CV 330001

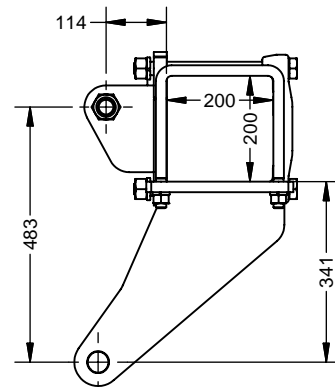
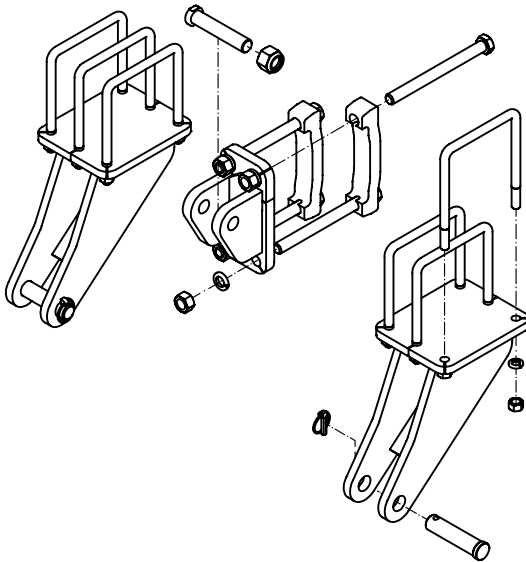

Diamond Bar Linkage P/N CV 330003

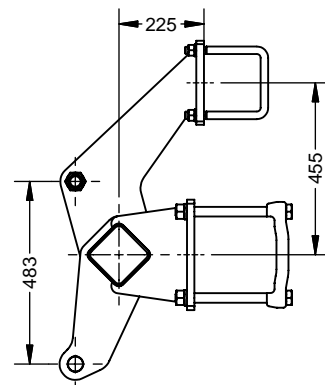
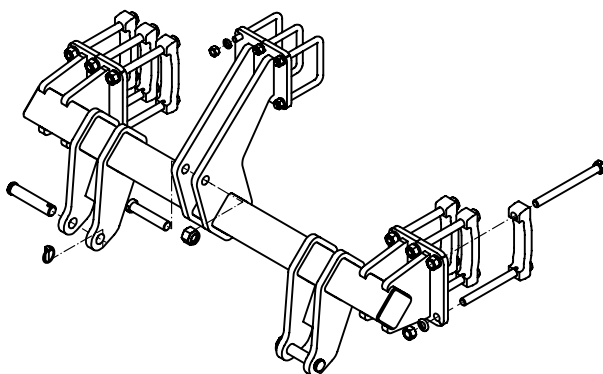

DEPTH GAUGE WHEELS

Light, medium and heavy duty kits available
to suit 6", 7", 8" Toolbars

Depth Gauge Wheel Assy

P/N FR 310228L
FR 310229R
CAPACITY 2.5T

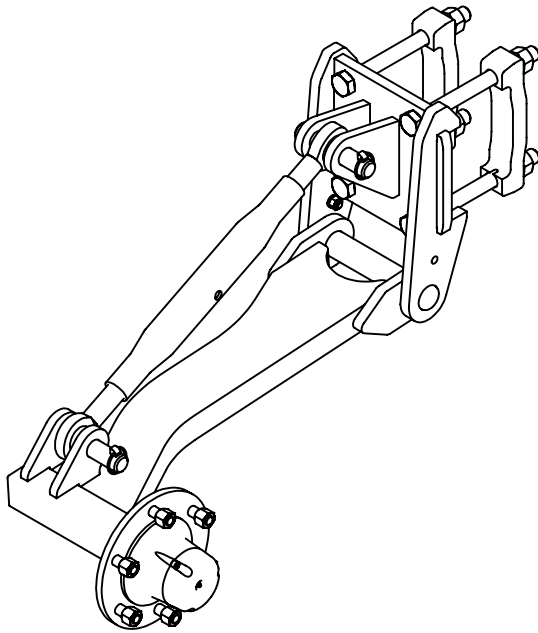

Depth Gauge Wheel Arms

P/N CV 330701L
CV 330701R
CAPACITY 1.5T

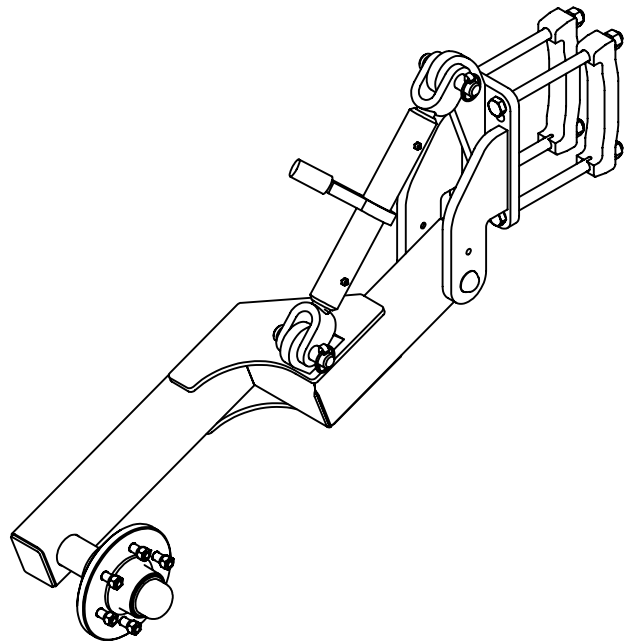

Depth Gauge Wheel Assy

P/N PE 390250L
PE 390250R
CAPACITY 2.5T

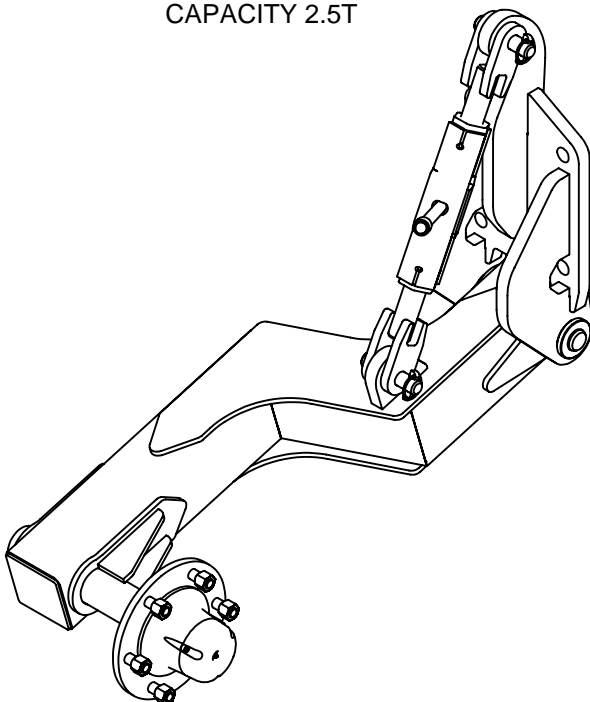

Depth Gauge Wheel

P/N SS 312050L
SS 312050R
CAPACITY 1.5T

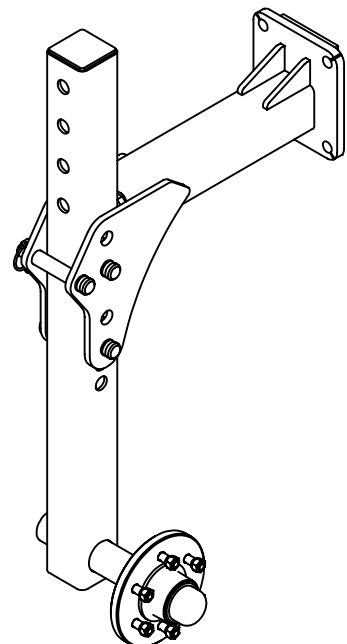

SHANKS AND CLAMPS

Large range of fixed & shear release type Clamps to suit
4",6",7" & 8" RHS.

Universal Shank Mount 3 x1
P/N CV 330212

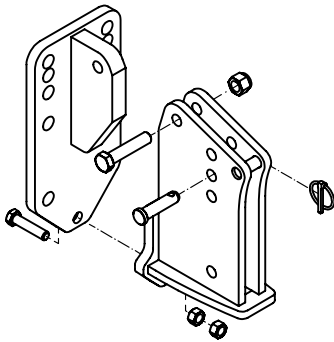

Universal Shank Mount 4 x1
P/N CV 330211

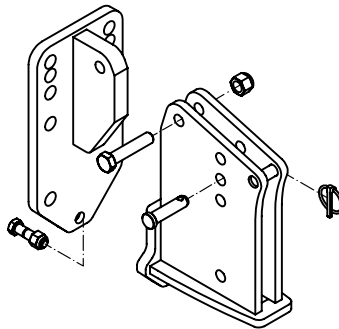

Shank Clamp Assy
P/N CV 330581

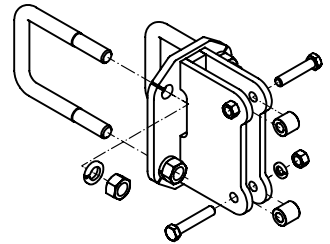

**Friction Trip
(Standard)**
P/N 303617

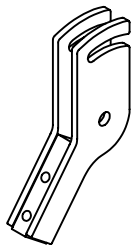

**Bolt Kit for Standard
Friction Trip**
P/N 3036073

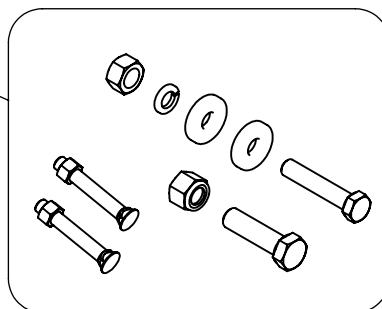

No 15 Furrower
P/N 303006

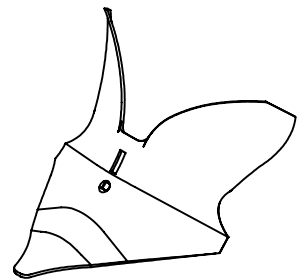

High Crown Alabama
P/N 3030021

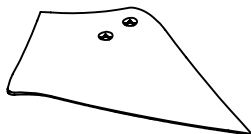

12" Supawing
P/N 303000

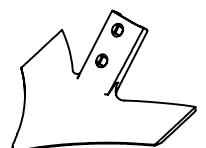

SHANKS AND CLAMPS

Various Shanks available for fertilising, planting, cultivating,
listing & ripping.

3 x 1 Planting Shank & 1.25" Drop Tube

P/N 404304

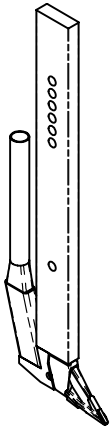

Front Shank

P/N 390300

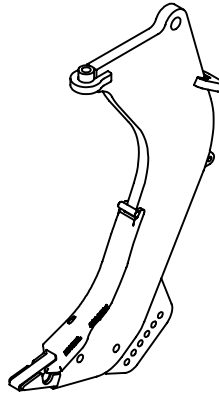

3 x 1 x 860 Adjustable Shank

P/N 330562



Stump Jump Assy suit 4", 6" Toolbars

SW 404403

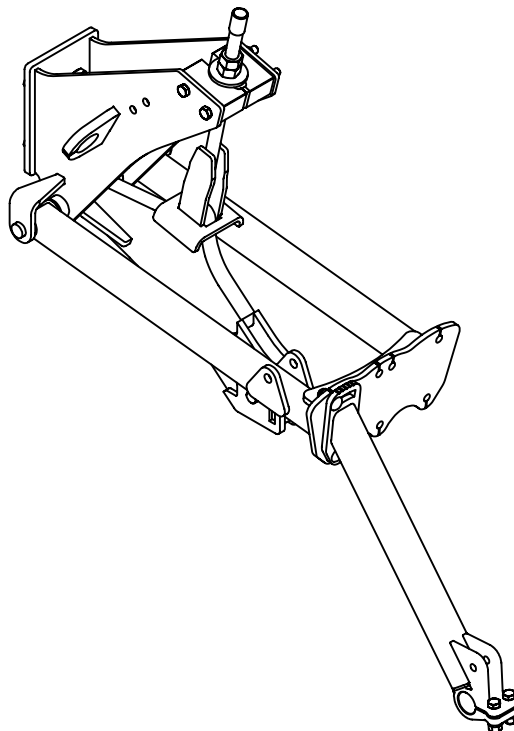

COULTER MOUNTS

A huge range of Discs available to suit Planters,
Stabilisers, Marker Arms & Guidance Systems.

1.5T Coulter Assy

P/N ESP 200520

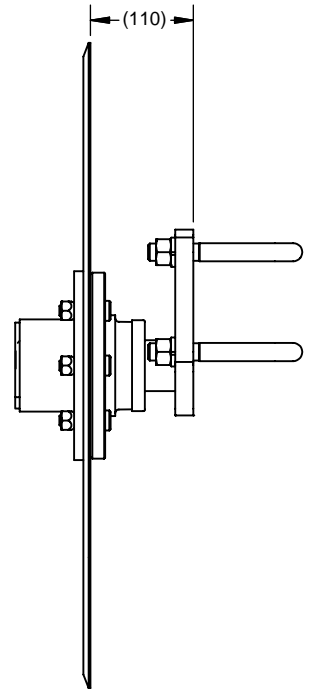
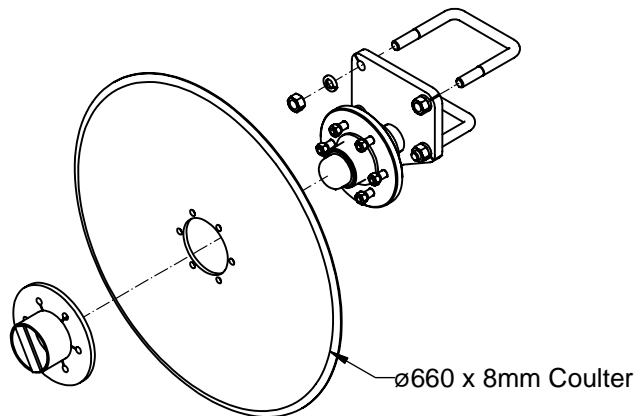

3.0T Coulter Assy

P/N ESP 200521

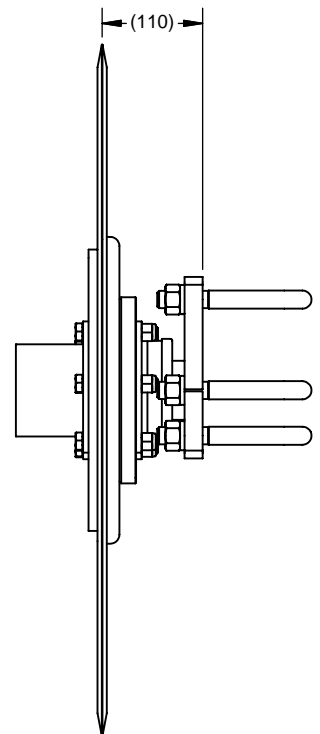
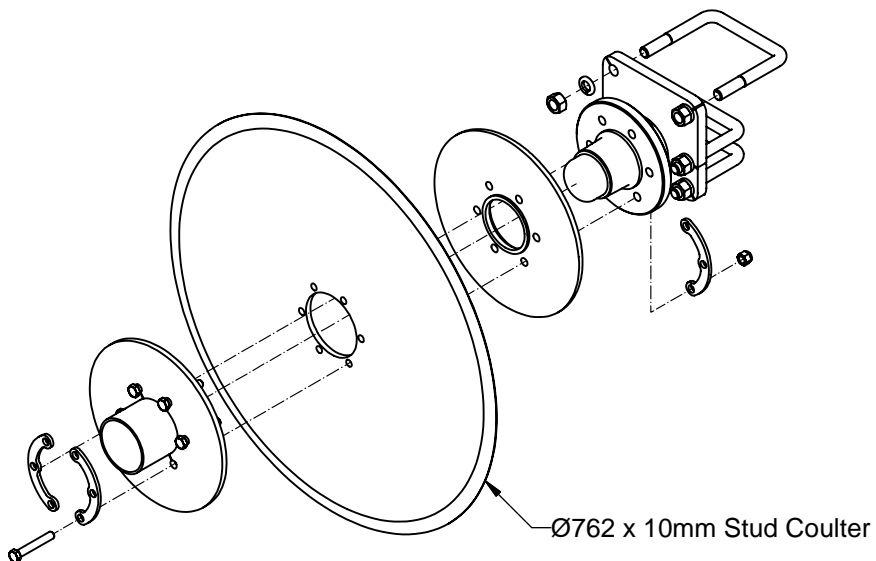

HUBS AND STUBS

HT Holden, 1.5 Tonne & 3 Tonne landcruiser, 2.5 to 6.5 Tonne
Bedford & other hubs up to 15 Tonne capacity available

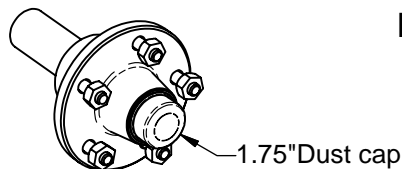

**HT Hub & Stub $\varnothing 39$ mm Axle
HT Stud Pattern**
P/N 303151

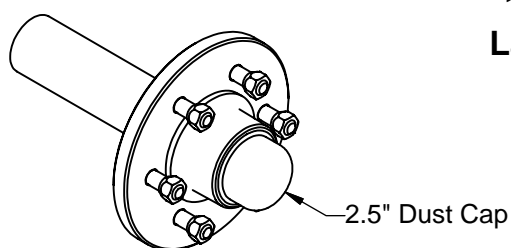
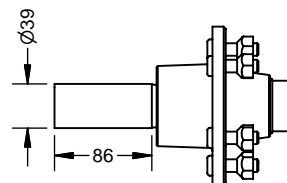

**1.5T 6 Stud $\varnothing 56$ mm Axle
Land Cruiser Stud Pattern**
P/N 303158

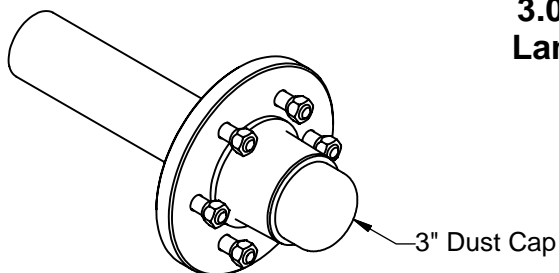
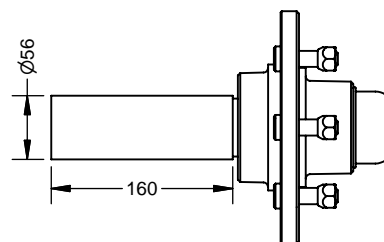

**3.0T 6 Stud $\varnothing 65$ mm Axle
Land Cruiser Stud Pattern**
P/N 801462

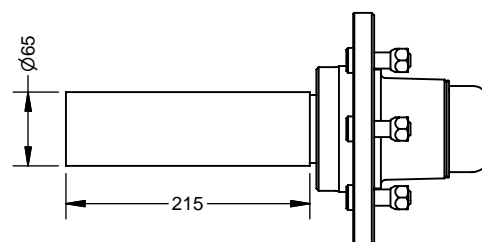

Tyres & Rims

Many different Tyres & Rims available to suit HT Holden, Landcruiser &
Bedford stud patterns

**7.50 x16 FT195 08Ply Tyre
Land Cruiser Stud Pattern
Sunraysia Rim**
P/N LB 800005



**7.50 x16 Multirib Tyre &
6S L/C Rim Assy**
P/N 304103

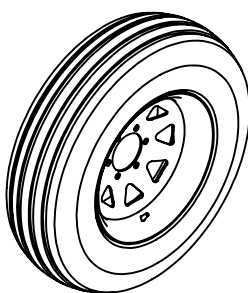

**11" x16" Multirib 8 Ply on
6 Std Bedford Rim**
P/N FR 310232

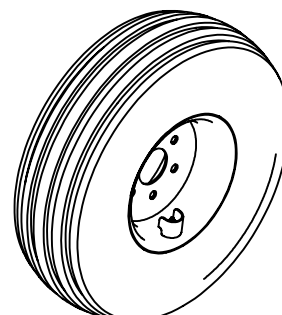

CLEAN SWEEP KITS

The revolutionary product for inter-row and fallow cultivating will suit most machines

Front Shank Clean Sweep Assy

P/N CV330201

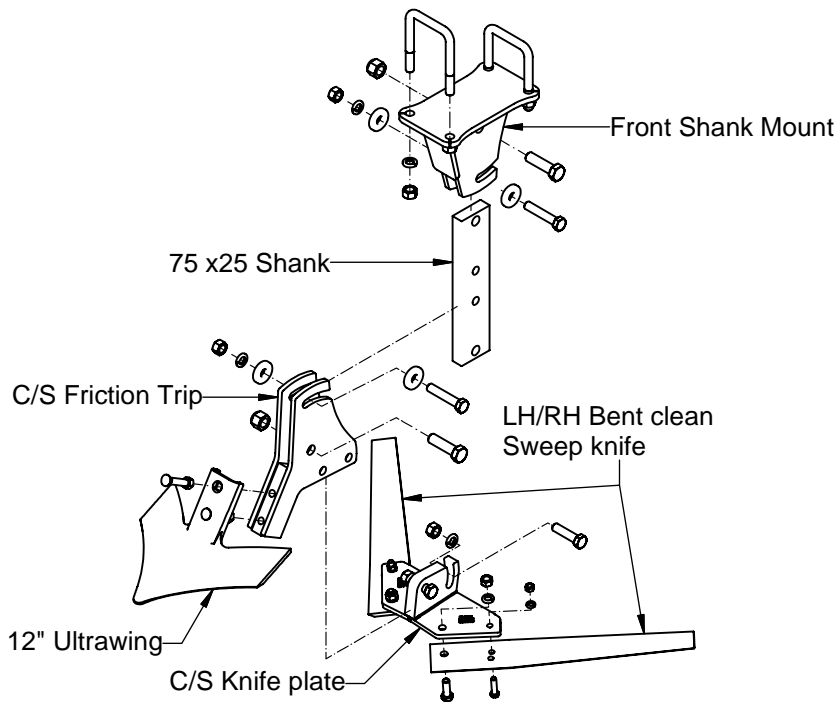

Bolt Kit for Clean Sweep Assy

P/N 3036074

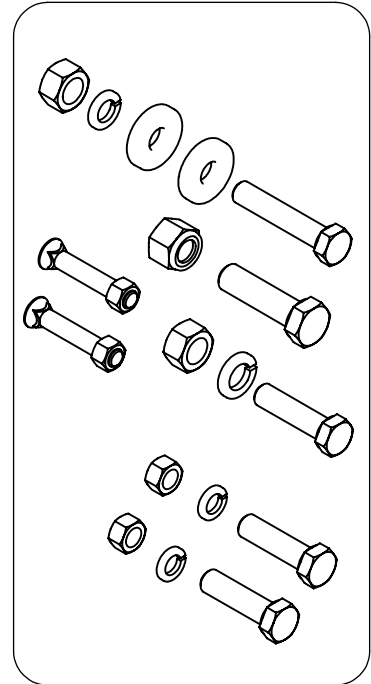

Clean Sweep Knives	
P/ Number	Discription
303100	400mm x 8mm Flat C/S Knife LH
303101	400mm x 8mm Flat C/S Knife RH
303102	400mm X 8mm Bent C/S Knife LH
303103	400mm X 8mm Bent C/S Knife RH
303104	500mm x 8mm Flat C/S Knife LH
303105	500mm x 8mm Flat C/S Knife RH
303106	500mm x 8mm Bent C/S Knife LH
303107	500mm x 8mm Bent C/S Knife RH
303108	680mm x 8mm Bent C/S Knife LH
303109	680mm x 8mm Bent C/S Knife RH
303110	680mm x 8mm Flat C/S Knife LH
303111	680mm x 8mm Flat C/S Knife RH
330551L	900mm x 12mm Flat C/S Knife LH
330551R	900mm x 12mm Flat C/S Knife RH

Clean Sweep Knives

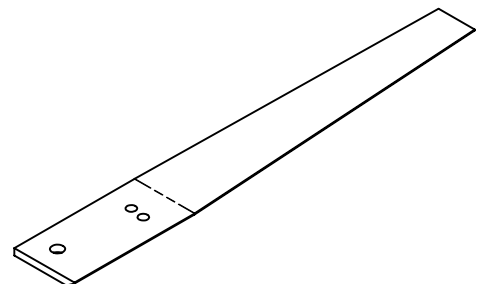

ROW UNITS

Parallelogram Assy

SW 404002

Versatile Parallelogram Assy to suit Excel Row Units. Fits most RHS sizes.

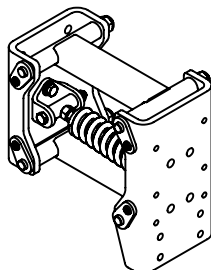

CR 600

The pinnacle in Parallelogram Tyne Planting equipment

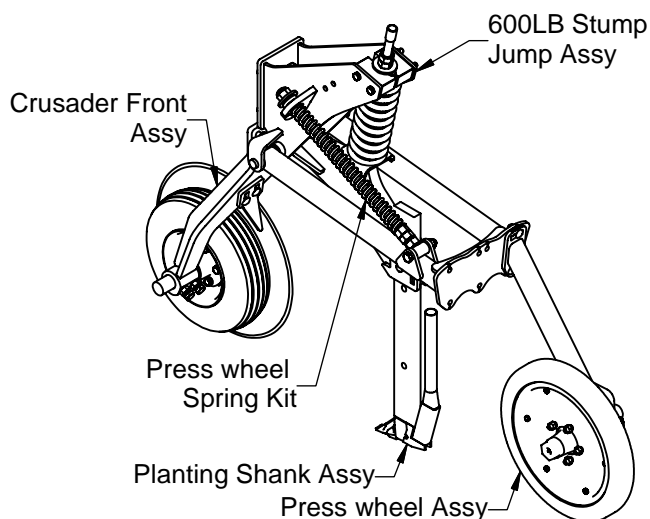

VT 430

Dominating the industry with the provision of a Disc opener & a Tyne on the one unit

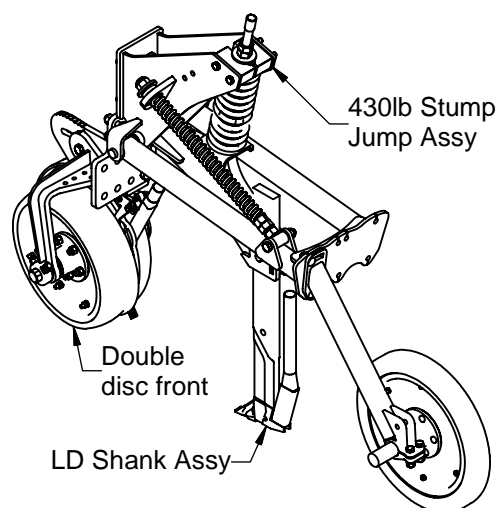

EI 853 Single Disc Opener

Ideal for seeding & fertilising into heavy trash cover.

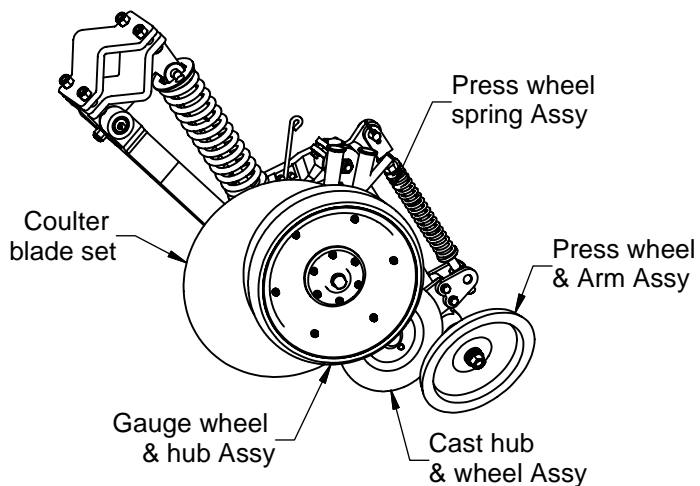

SP 200

High performance heavy duty Double Disc Opener

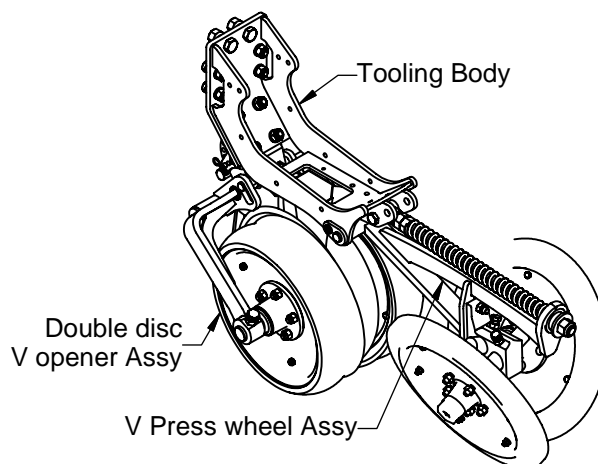

ACCESSORIES

U Bolts

Available to suit common RHS sizes
between 2"x 2" & 8" x 8".

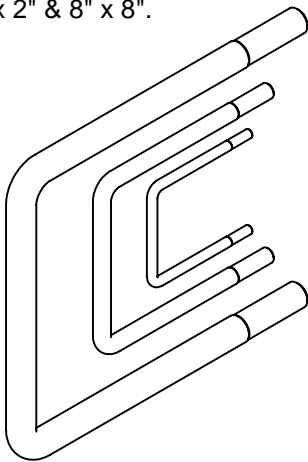

Cultipacker Rings

12" standard and 14" heavy duty
rings available

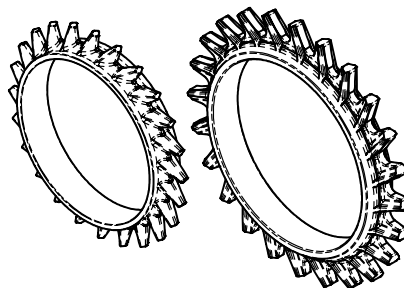

1.25 "Square Shank

P/N 303612



D Cup Diffusers

Increase germination through accurate seed placement
& improve the performance of both of Tyne Planting
& Disc opener machinery.

D-Cup Diffuser single

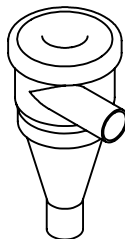

D-Cup Diffuser double

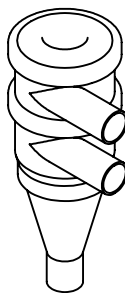

D-Cup Diffuser triple



Stainless steel Liquid Droppers

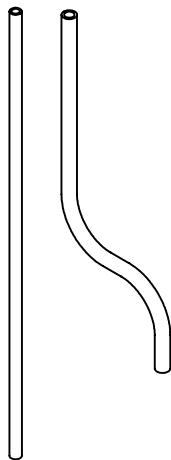

Friction Trip (Small)

P/N 303616

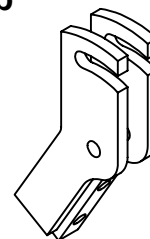

Swept Gas Knife

P/N 330556

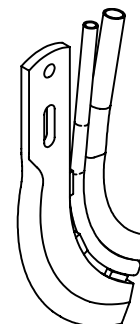

Fertiliser Knives

P/N 303131(1.25" tube)
303132 (2" tube)

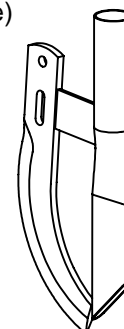

Shell Clamps

Available in 4", 6", 7", & 8"

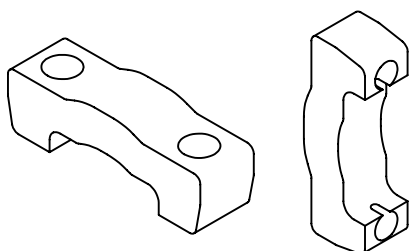

[illegible]





Edition 1 Apr 07